

Market Model: MGS80M090B4A

Product Code: 220082200180

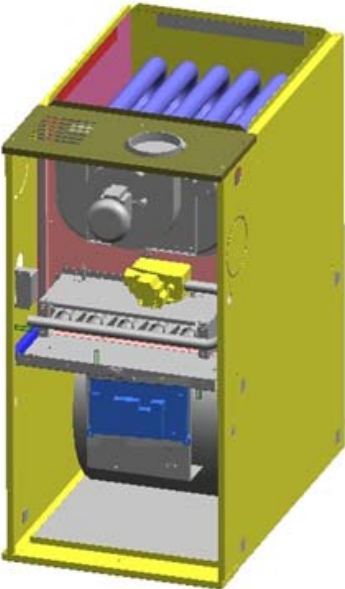

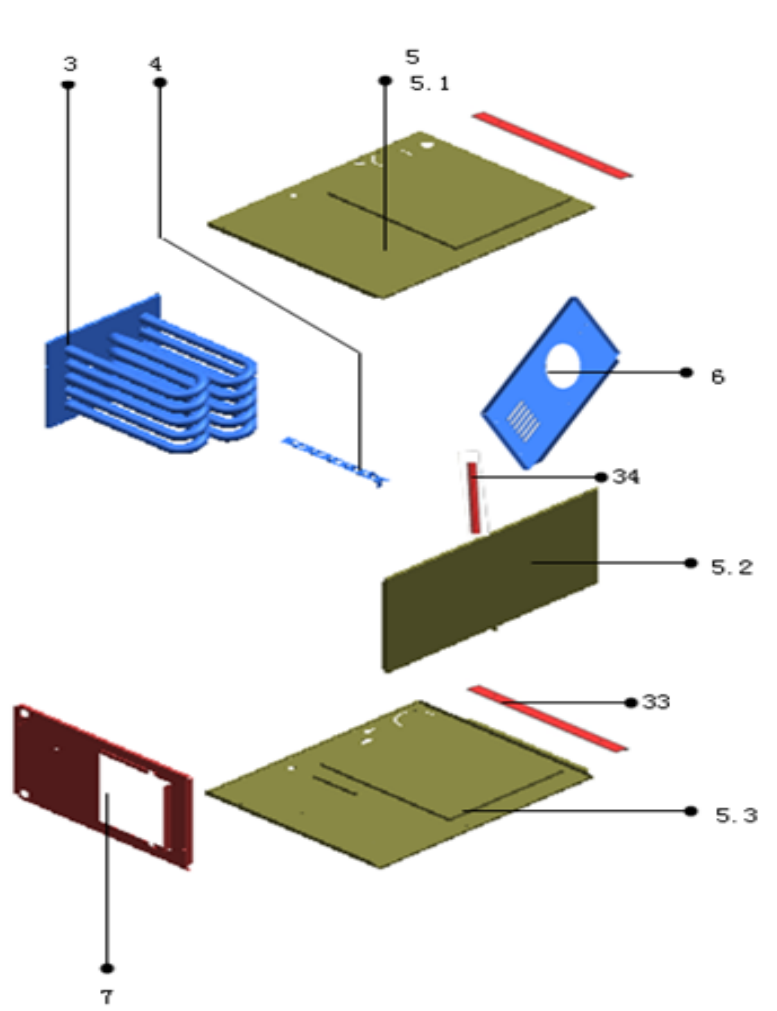
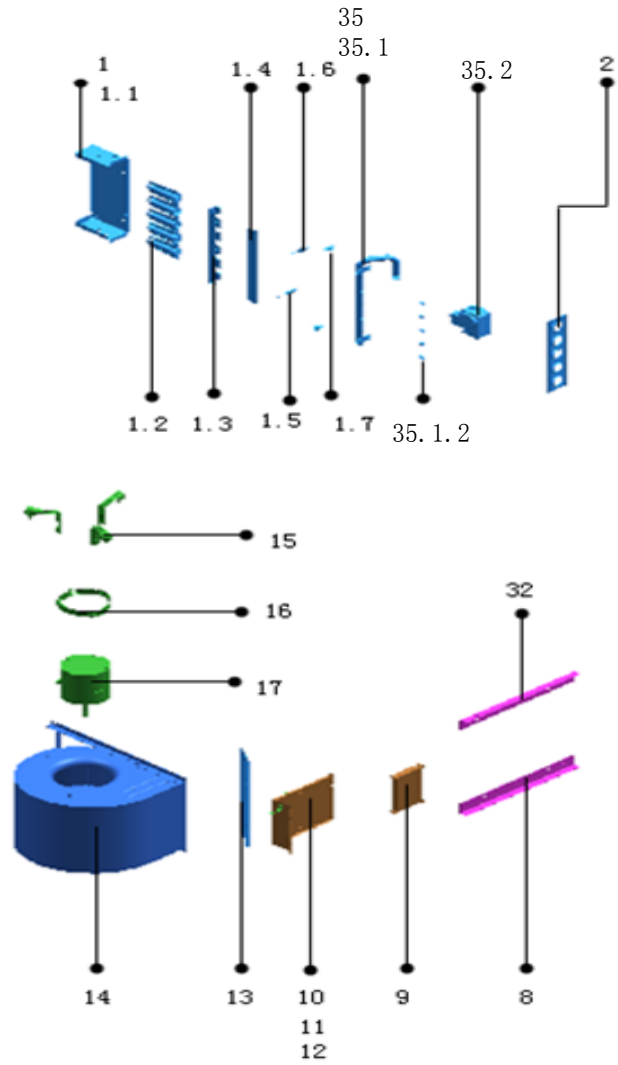
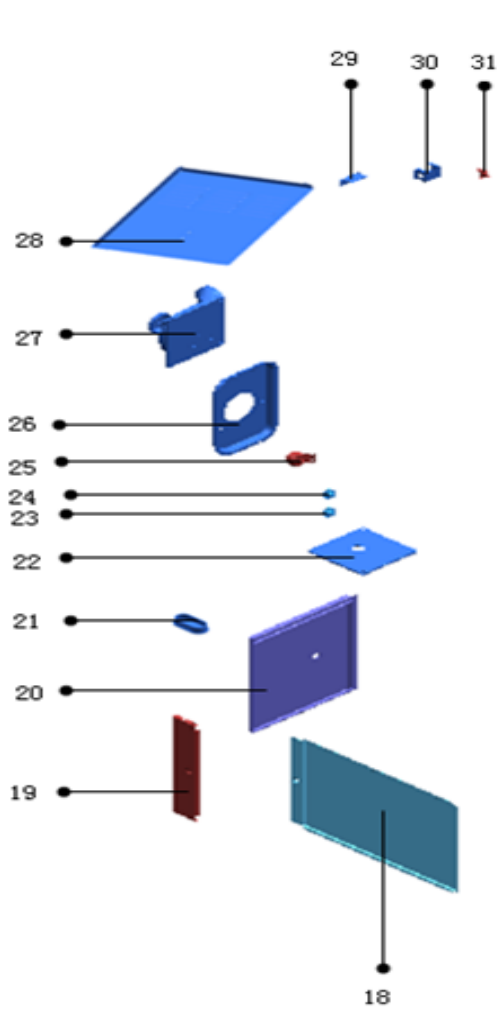

No.	中文	Part Name	Quantity	BOM code	Price(\$\$)	Remark
1	燃烧器组件 (RoHS)	Burner Components	1	201282290042		
1.1	燃烧器固定支架 (RoHS)	Burner mounting bracket	1	201282290044		
1.2	燃烧器	Burner	5	202419900251		
1.3	燃烧器固定板 (RoHS)	Fixed plate burner	1	201282290043		
1.4	燃烧器挡板 (RoHS)	Burner baffle	1	201282290039		
1.5	火焰传感器	Flame sensor	1	202301300524		
1.6	点火针	Firing pin	1	202319900965		
1.7	温控器 (手动复位) (RoHS)	Thermostat	2	202301600596		
2	导流板 (RoHS)	Deflector	1	201282290032		
3	换热管组件	Tube Components	1	201282200002		
4	扰流片 (RoHS)	Spoiler	5	201282290003		
5	箱体组件 (SB3053, RoHS)	Cabinet Components	1	201282290087		
5.1	右侧板 (SB3053, RoHS)	Right side of the board	1	201282290085		
5.2	后板 (SB3053, RoHS)	Plate	1	201282290088		
5.3	左侧板焊接件 (SB3053, RoHS)	Welding pieces left	1	201282290084		
6	上前盖板 (SB3053, RoHS)	Front cover	1	201282290089		
7	中隔板组件 (RoHS)	Components in the partition	1	201282290037		
8	左支撑条 (RoHS)	Article support	1	201282290011		
9	电控主板	Electronic Control Board	1	201319902224		
10	电控安装板焊接件 (RoHS)	Electronic control mounting plate weld	1	201282290001		
11	压缩机电容 (RoHS)	Capacitor	1	202401000884		
12	电源变压器 (无保险丝)	Power transformer	1	202300930211		
13	风道挡板 (RoHS)	Duct damper	1	201282290029		
14	离心风机	Centrifugal fan	1	201200300229		
15	电机支架组件I (RoHS)	Motor bracket I	3	201270390288		
16	电机支架 II	Motor bracket II	1	201282200014		
17	异步电机 (RoHS)	Induction motor	1	202400400673		
18	底部密封板	The bottom of the seal plate	1	201282290028		
19	下支撑板 (SB3053, RoHS)	Under the support plate	1	201282290092		
20	下盖板 (SB3053, RoHS)	Under cover	1	201282290091		
21	长形透明塑料盖 (RoHS)	Long-shaped transparent plastic cover	1	201182290002		
22	排烟挡板 (RoHS)	Exhaust baffles	1	201282290115		
23	温控器 (RoHS) (UL)	Thermostat	1	202301600543		
24	温控器 (RoHS) (UL)	Thermostat	1	202301600542		
25	风压传感器	Pressure Sensor	1	202301300525		
26	集气罩 (RoHS)	Set hood	1	201282290031		
27	排烟风机组件	Exhaust fan components	1	202400504278		
28	上盖板 (SB3053, RoHS)	On the cover	1	201282290090		
29	接线盒盖 (RoHS)	Junction box cover	1	201282290007		
30	接线盒 (RoHS)	Junction Box	1	201282290008		
31	门开关	Door switch	1	202301800865		
32	支撑条 (ROHS)	Article support	1	201282290114		
33	左右侧板玻璃棉压板	Left and right side plate glass wool	2	201282290122		

34	后侧板玻璃棉压板	After the side glass wool plate	1	201282200015		
35	燃气管部件	Gas Components	1	201682290010		
35.2	燃气阀	Gas valve	1	201601601252		